

F.
PROFILÉ
STANDARD

SOMMAIRE

Profilé Standard







F1

Cornière LégèreP07 - 12

F2

Tubes.....P13 - 18

F1.
CORNIÈRE
PROFILÉ STANDARD

RÉF	SÉCTION	DÉSIGNATION
917006		CORNIÈRE LÉGÈRE 15
917007		CORNIÈRE LÉGÈRE 20
917008		CORNIÈRE LÉGÈRE 25
917009		CORNIÈRE LÉGÈRE 30
917011		CORNIÈRE LÉGÈRE 40
917012		CORNIÈRE LÉGÈRE 50

RÉF	SÉCTION	DÉSIGNATION
-----	---------	-------------

917010



CORNIÈRE LOURDE 30X30X2.5

917013



CORNIÈRE LOURDE 50X50X3

CORNIÈRE

917006

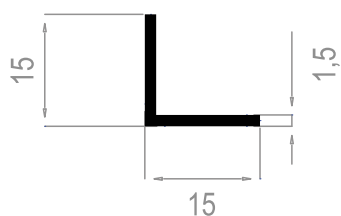

917007

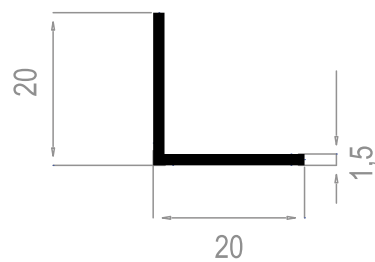

917008

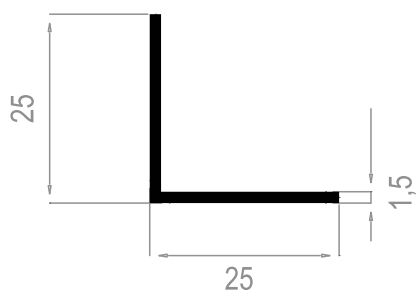

917009

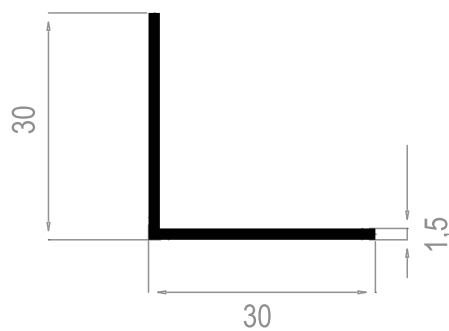

917011

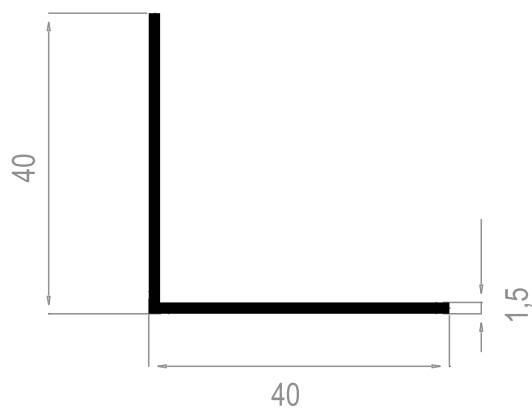

917012

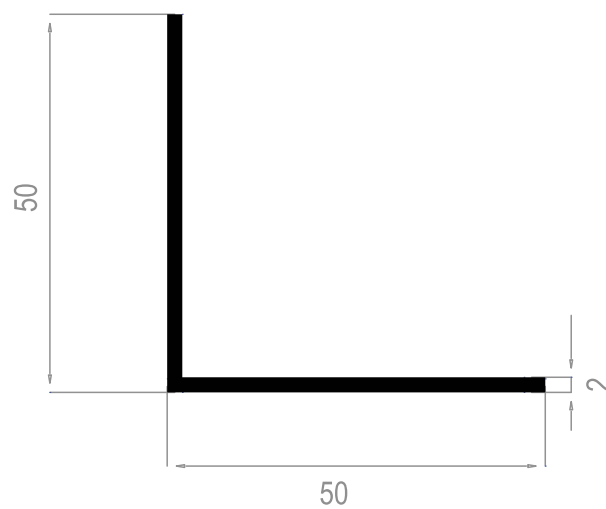

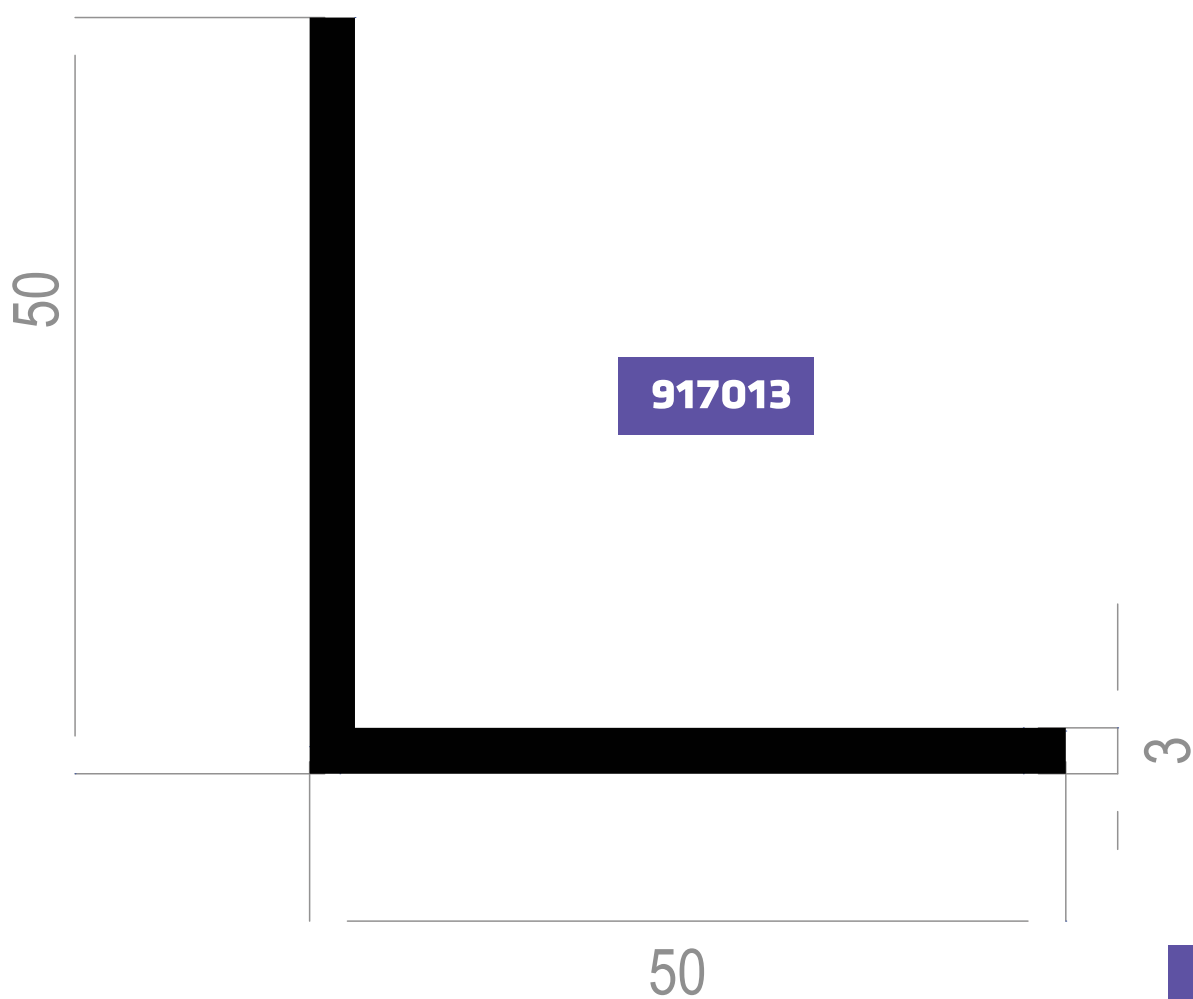
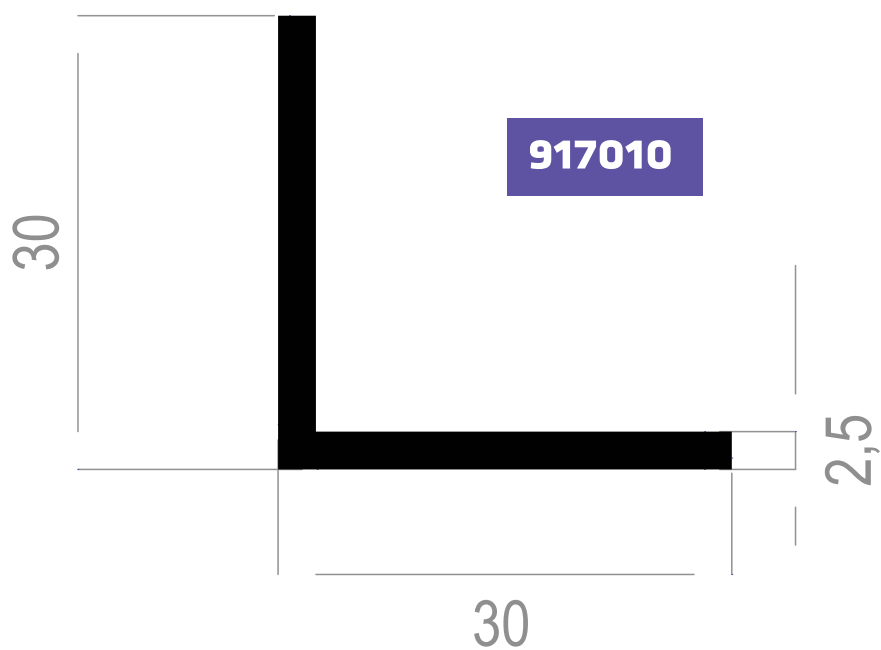

CORNIÈRE



F2. TUBES

PROFILÉ STANDARD

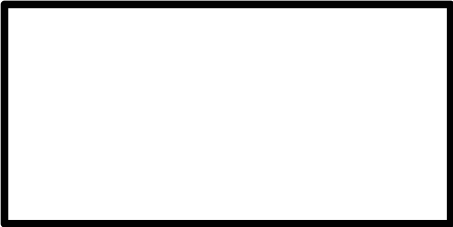
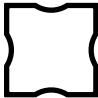
RÉF	SÉCTION	DÉSIGNATION
GC 5763		RECTANGLE 20X35/0.9
GC 5762		RECTANGLE 20X40/0.9
GC 6412		RECTANGLE 60X120/2
GC 6040		TUBE CARRÉ 25X25/1.4
?????????	???	MAÇON
?????????	???	MAÇON

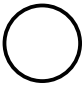
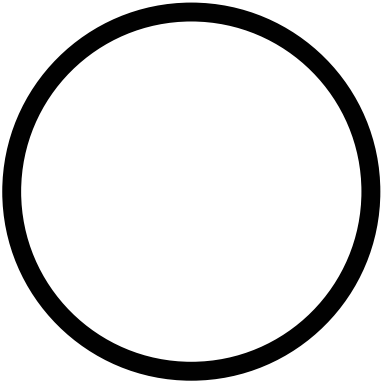
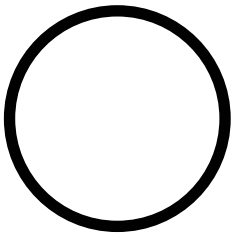
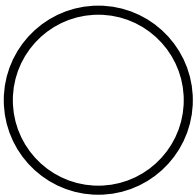
RÉF	SÉCTION	DÉSIGNATION
???		TUBE ROND Ø10
???		TUBE ROND Ø 50/1.2
GC 6042		TUBE ROND Ø 30/1.5
GC 6041		TUBE ROND Ø25/1.2

TUBES

GC 5763

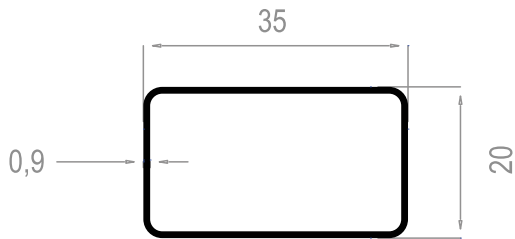

GC 5762

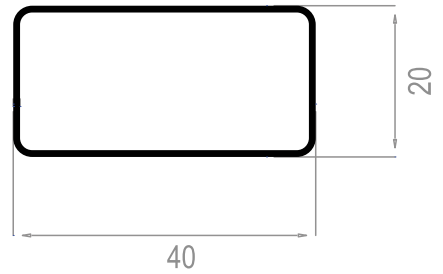

120

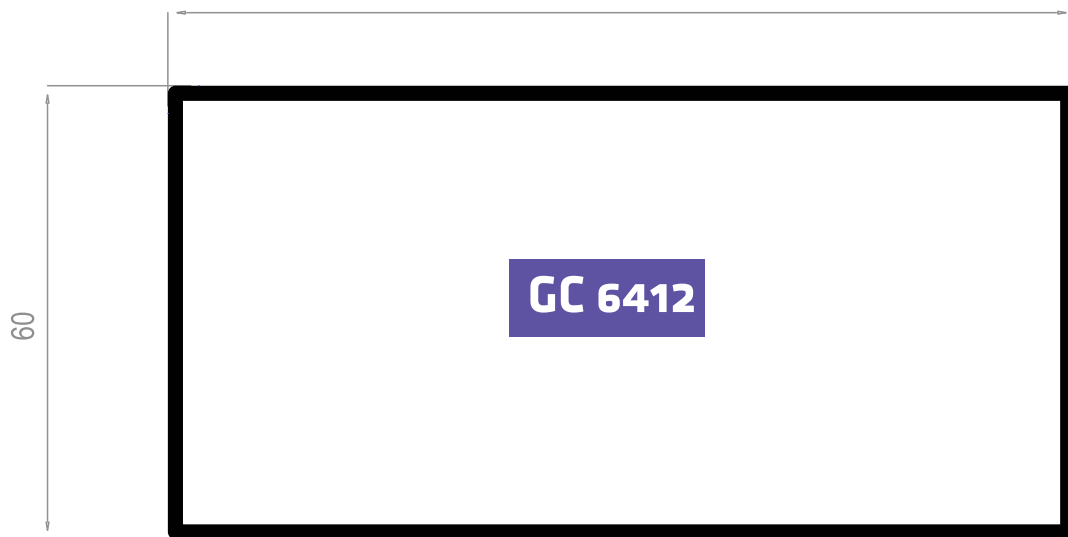

GC 6412

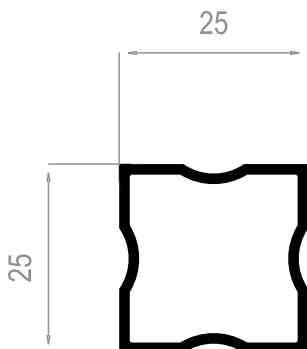

GC 6040

???

???????

???

??????

TUBES

??????

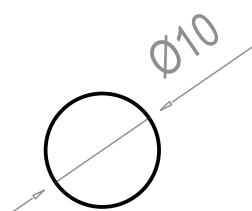

??????

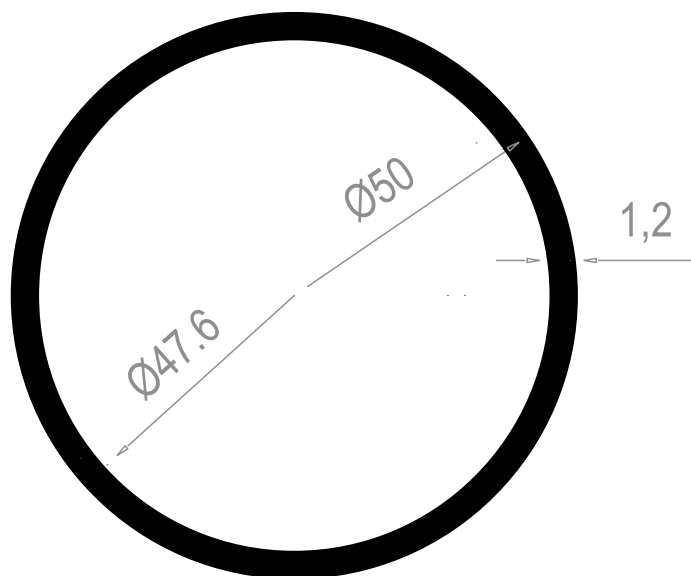

GC 6042

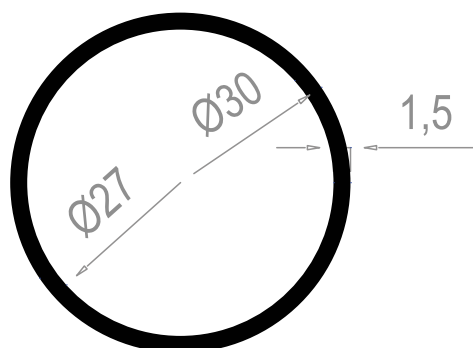

GC 6041

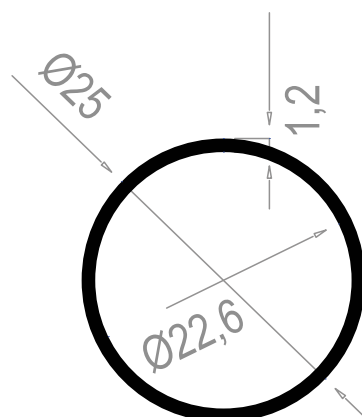

The background of the image features several dark, metallic extrusion profiles, likely aluminum, arranged in a geometric pattern. The profiles have various cross-sectional shapes, including T-shapes and more complex multi-chambered designs. They are set against a dark, textured background that emphasizes their industrial nature.

fm FORZA METAL



 www.forza-metal.com

 info@forza-metal.com

 *Zone industrielle el eulma, Sétif*